



Maintenance Bypass Switch

PSMBS2K / PSMBS3K

QUICK GUIDE



1. Introduction

The PowerShield Maintenance Bypass Switch (PSMBS) is used as an external power distribution unit in conjunction with UPS systems or large-scale voltage regulators. It allows for the manual transfer of connected equipment to utility power via a bypass switch, permitting scheduled maintenance or UPS replacement without power interruption.

Rack Mount/Wall Mount the Unit

The module can be mounted to a 19" enclosure or wall. Please follow the chart below for rack/wall mount installation.

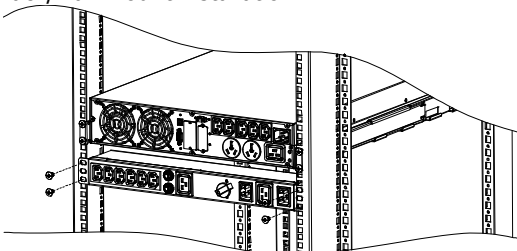

Chart 1: Rack mounting

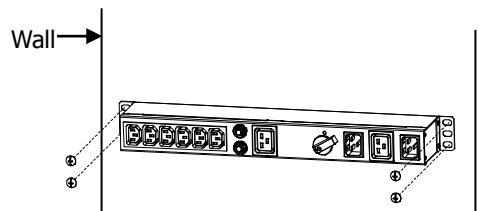
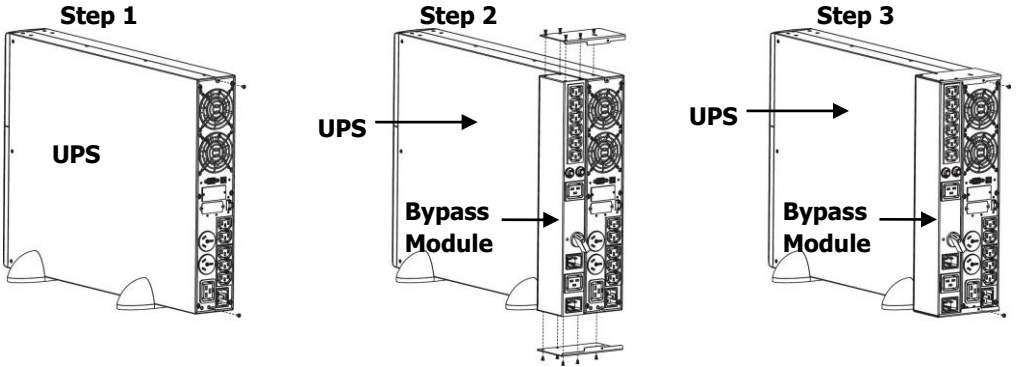

Chart 2: Wall mounting

Tower Installation

This module also can be placed on the desk as tower unit. Please follow below steps to install the module attached to the UPS.



2. Product Overview – PSMBS 2K / PSMBS 3K PSMBS 2K

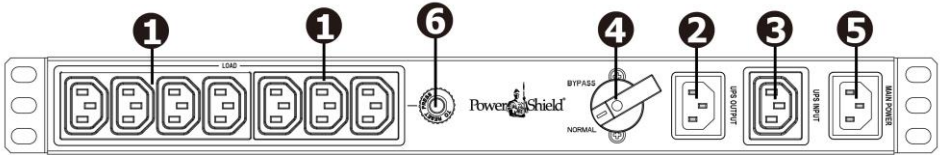

PSMBS 3K

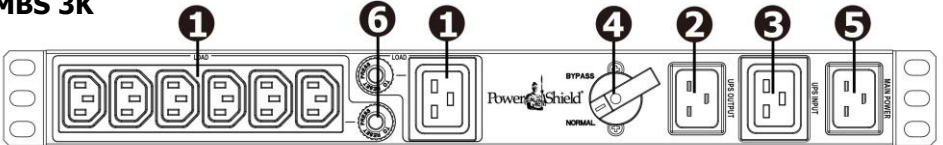

- ❶ Output receptacles
- ❷ Socket to UPS output
- ❸ Socket to UPS input
- ❹ Bypass switch
- ❺ AC input
- ❻ Circuit breaker

3. Installation and Operation

Inspection

Remove the unit from the shipping package and inspect it for damage that may occur during transportation. Notify the carrier and place of purchase if any damage is found.



The shipping package contains:

- PowerShield Maintenance Bypass Switch (PSMBS) module x 1
- Quick guide x 1
- Mains power cord x 1
- UPS input power cord (blue) x 1
- UPS output power cord (red) x 1
- Screws and mounting ears

Connect to the Wall Outlet

Use the power cord provided to connect the AC input socket on the PSMBS module to the utility wall outlet socket.

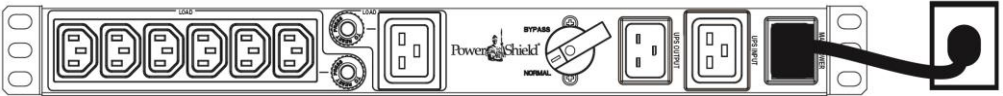

Connect UPS

Use the power cord provided (Blue), to connect UPS input to UPS input socket on the PSMBS module. Use the power cord provided (Red) to connect UPS output to UPS output socket on the PSMBS module.

Online UPS

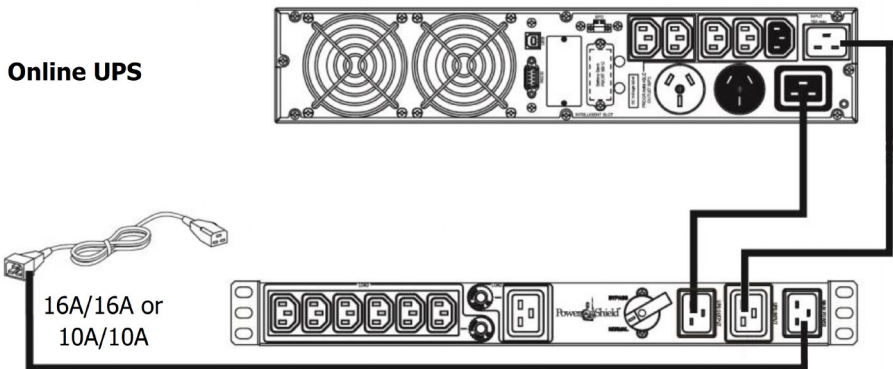

Connect Equipment

Connect equipment to the output sockets of the PowerShield Maintenance Bypass Switch module. Please refer to the chart below for equipment connection.

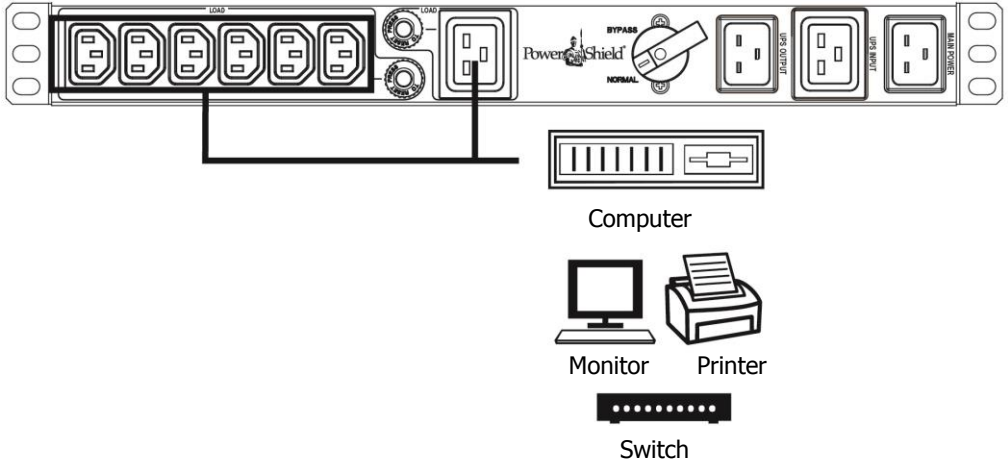

4. Operation

Transfer to Maintenance Bypass

Before transferring to maintenance bypass, make sure the utility Power is ON. Transfer the rotary bypass switch from "Normal" to "Bypass". At this time, all connected devices are powered by the utility power directly. Turn off the UPS and disconnect the two power cords connecting to the UPS. Commence service and maintenance of the UPS.

Transfer to UPS Protection

After maintenance service is done, make sure the UPS operation is normal. Then, reconnect the UPS to the PowerShield Maintenance Bypass Switch module by following the previous Installation Section. Then transfer the rotary bypass switch from "Bypass" to "Normal". Now, all connected devices are protected by the UPS.

5. Important Safety Warning (SAVE THESE INSTRUCTIONS)

To safely operate this PSMBS module, please read and follow all instructions carefully. Read this manual thoroughly before attempting to unpack, install, or operate. Safely store this quick guide for further reference.

CAUTION: The product must be used indoor only.

CAUTION: Do not place the unit near liquid or in an excessively damp environment.

CAUTION: Do not place the product directly in the sun or near a hot source.

CAUTION: Do not let liquid or foreign objects enter the product.

CAUTION: Ground the product using a 2P + ground sockets.

CAUTION: When installing the product, ensure that the sum of the leakage currents of the product and the devices it supplies not exceed 3.5mA.