

PowerShield®



USER MANUAL

SafeGuard UPS 750VA (PSG750)



INTRODUCTION

Thank you for choosing PowerShield. This PowerShield UPS is designed to provide safe and reliable usage with minimal maintenance. Before you start please read this manual. It contains

instructions relating to safety, installation, operation, maintenance and warranty of this UPS. Please keep this manual in a safe place for future use.

PACKAGE CONTENTS

Included in the box:

- PowerShield SafeGuard 750VA UPS
- PowerShield User Manual
- Communication / USB cable

Note: Before installation, please inspect the unit for any damage that may have occurred during transit. If any damage is found, please notify your dealer. Please keep the packaging in the event the product needs to be returned to a repair centre for service.

PRODUCT OVERVIEW

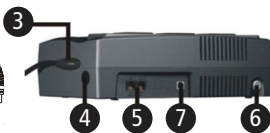
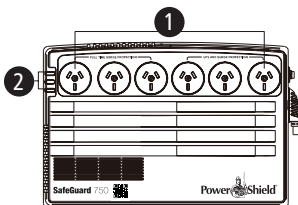

- 1 6 Outlets: 3 UPS plus full time surge protection and 3 full time surge protection only
- 2 LED status indicators
- 3 AC input power cord
- 4 5A Input circuit breaker
- 5 Phone, Fax, Modem (Not NBN) Surge Protection
- 6 ON/OFF push button power switch
- 7 USB connector for communications

GETTING STARTED

PLACEMENT

Avoid placing SAFEGUARD in:

- Direct sunlight
- Excessive heat
- Excessive humidity or in contact with fluids of any type

CONNECTING EQUIPMENT AND INITIAL START UP

Plug the AC input cord into the wall outlet. Turn on the UPS by pressing the "ON/OFF" button on the UPS. For the best results, charge the battery for at least 6 hours before initial use. Once UPS is fully charged proceed to connect equipment.

BATTERY BACKUP OUTLETS – UPS & SURGE PROTECTION (x3)

Only devices that require battery backup such as PCs should be plugged into these outlets.

FULL TIME SURGE ONLY PROTECTED OUTLETS (x3)

Devices like printers that do not require battery backup should be plugged into these outlets. These devices will be protected against surges and spikes.

CAUTION: NEVER connect a laser printer or scanner to the battery backup outlets. This may cause damage to the unit.

CONNECTING USB COMMUNICATION CABLE

To allow for unattended OS shutdown, start up and status monitoring, connect the USB communication cable at one end to the UPS and the other end to the PC.

COLD START FUNCTION

When the UPS is 'OFF' and there is no utility power, it is still possible to cold start the UPS to power the loads providing your battery has sufficient charge.

WALL MOUNTING OF UPS

The SafeGuard 750VA UPS can be mounted to a wall surface. Use the template provided on the carton as a template to position the mounting fasteners (not supplied). Wall mount this product as follows:

- 1 Cut the template from your carton and use the template to mark the location of the fastener locations.
- 2 Install the mounting fasteners, leaving the head of both fasteners 8mm out from the wall. The fastener should be capable to support 7 kg.
- 3 Mount the unit by positioning the keyhole slots over the mounting fastener heads.

STATUS INDICATOR AND BEEPER

The SafeGuard 750VA UPS provides status indicator through three LEDs located at side of the product as well as audible beep. The indications are shown below.

STATUS	GREEN LED	YELLOW LED	RED LED	BEEPER
On line operation	Solid on	Off	Off	No beep
On battery operation	Off	Solid on	Off	2 beeps every 30 sec
Low battery status	Off	Flashing (1 flashing every one sec)	Off	Rapid beep (one second intervals)
On line overload	Solid on	Off	Solid on	Constant beeping
On battery overload	Off	Solid on	Solid on	Constant beeping
Bad battery detected	Flashing (1 flashing every 1 sec)	Off	Flashing (1 flashing every 1 sec)	Constant beeping
Internal Fault	Off	Off	Solid on	Constant beeping
Unit performing battery test via software	Flashing (1 flashing every 1 sec)	Solid on	Off	No beep

SOFTWARE INSTALLATION

- 1 Download and install the latest NetGuard UPS monitoring Software from: <https://powershield.com.au/support-menu/download-area/netguard-software-downloads/>. Follow the on-screen instructions to install the software.
- 2 When your computer restarts, the monitoring software will appear as a NetGuard icon located in the system tray, near the clock.
- 3 Default password is: administrator

NATIVE BATTERY MANAGEMENT

PSG750 UPS models support Human Interface Device (HID) protocol for inbuilt native battery management compatible with Windows and Mac OSX.

If you wish to use NetGuard Monitoring Software please follow the instructions above.

BATTERY REPLACEMENT

The SafeGuard 750 has a user replaceable battery. Please read the following in conjunction with the safety instructions:

- 1 Turn the unit over and remove the screw located on the bottom of the UPS to open the battery cover.
- 2 Slide open the battery cover.

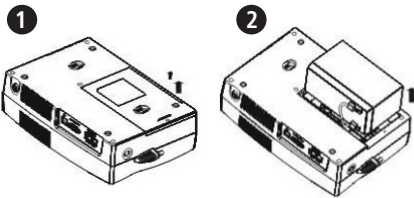

- 3 Lift the battery out of its compartment and disconnect first the red and then the black wire connecting it to the UPS. Replace with the same type of battery. Reconnect first the black wire and then the red wire on the new battery. Replace the new battery in its compartment.

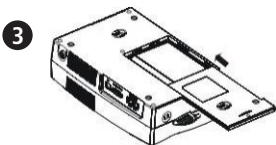

- 4 Slide back the battery compartment cover to close the battery housing. Fasten the cover screw to secure the cover.

SAFETY CAUTION

Please read carefully the following safety instructions before using the SafeGuard 750 UPS.

ATTENTION: Electrical Safety

- To prevent the risk of fire and electric shock, install the product in a controlled temperature and humidity indoor area where it is free from conductive contaminants.
- To reduce the risk of overheating, please ensure the cooling vent holes are unobstructed.
- This product is not approved for medical equipment, or life-support systems.
- Hazardous voltages present even when the unit is disconnected from the mains. Hazardous voltages may still be present through the supply from the battery. Battery connections should be disconnected when servicing the product.
- There are no serviceable parts inside the unit. Please do not attempt to open enclosure for modification or service, other than replacing the battery. Any modification whatsoever to this unit will void product warranty.

ATTENTION: Battery Safety

- When replacing the batteries, always use the same quantity and type of batteries.
- Do not dispose of batteries in a fire as they may explode.
- Do not open or mutilate the battery as released electrolyte may be harmful to the skin and eyes.
- A battery can present a risk of electric shock and high short circuit current.
- Battery replacement should be only undertaken by competent personnel.
- The following precautions should be observed before replacing batteries.
 - 1 Remove watches rings and other metal objects.
 - 2 Use proper tools with insulated handles.
 - 3 Keep tools or metal objects away from the batteries.
 - 4 Make sure that the UPS is turned OFF.
 - 5 Disconnect mains supply prior to connecting or disconnecting battery terminals.

WARNING: This is a category C2 UPS product. This product may cause radio interference.

TROUBLESHOOTING

Please follow the trouble shooting section below. If the problem cannot be resolved, please check the PowerShield FAQ web page or call our customer support for further assistance.

PROBLEM	POSSIBLE CAUSES	SOLUTIONS
LED not lit	Battery may be faulty	Replace the battery with PowerShield battery.
	Input circuit breaker tripped	Check circuit breaker and wait 15 minutes and check again.
Continuous beeping while input utility power is normal	The unit may be overloaded	Remove some equipment that is connected to UPS outlets and check load level indicator on LCD display.
Continuous beeping while UPS operating	The battery is low/faulty	Replace battery with PowerShield battery.
Backup time is short/none when power fails	Equipment may be connected to surge protection outlets	The surge protection does not have battery backup function. Connect your equipment to UPS battery backup outlet if it is required for battery backup.
	Overload	Remove some equipment that is connected to UPS outlets.
	Low battery	Recharge the unit for at least 6–8 hours and try to start it again.
	Battery may be faulty	Replace the battery with PowerShield battery.
The unit stays on battery when the mains power has returned	Input circuit breaker tripped	Check circuit breaker and wait 15 minutes and check again.
	Input power cord may be loose	Check the power cord is connected to the wall outlet securely.

If any abnormal situations occur that are not listed above, please call for service immediately.

SPECIFICATIONS

Specifications are subject to change without notice:

MODEL	PSG750
CAPACITY	750VA / 450 W
Input Voltage	240VAC
Input Voltage Range	177–290VAC
Output Voltage Regulation	240VAC ± 10%
Transfer Time	Typical 6 ms
Waveform	Simulated Sine Wave
Battery Type & No	12V/9Ah x 1
Charging Time	6–8 hours recover to 90% capacity
Surge Protection	468 J / 11000 A
Dimension (L x W x H)	292 x 199 x 91 mm
Net Weight	6.3 kgs
Humidity & Temperature	0–40°C @ 0–90% RH (non-condensing)
Altitude	0–2000 m
Noise Level	Less than 40dB
Safety	EN62040–1:2008+A1:2013
EMC	EN IEC 62040–2:2018 Revised 2015
RoHs	2011/65/EU

WARRANTY AND SERVICE

WARRANTY CONDITIONS

The standard warranty is two (2) years from the date of purchase. For Warranty Conditions please visit: <https://powershield.com.au/wp-content/uploads/Warranty/PowerShield-WARRANTY.pdf>

WARRANTY CLAIMS

First please follow the troubleshooting procedure described above. If you are unable to solve your problem please call +61 8 9209 3839 or 1300 305 393. You will be required to provide the following details:

The model number, serial number, and the date of purchase of the UPS. Be prepared to troubleshoot the problem over the telephone with technical support. If unsuccessful the technical support team will issue a Returned Material Authorization (RMA) Number & Warranty Procedure Document. Our technical support personnel will also guide you through the process.

Please register your warranty by visiting www.powershield.com.au