

POWER SHIELD

Batteries



PSB12-7.2 (12V7.2Ah)

GENERAL FEATURES

- Absorbent Glass Mat (AGM) technology for efficient gas recombination of up to 99% and freedom from electrolyte for air transport-complies with LATA/ICAO Special provision A67.
- Not restricted for air transport-complies with LATA/ICAO Special Provision A67.
- UL-recognized component.
- Can be mounted in any orientation.
- Computer designed lead, calcium tin alloy grid for high power density.
- Long service life, float or cyclic applications,
- Maintenance-free operation.
- Low self discharge.
- Case and cover available in both standard and flame retardant ABS.



SPECIFICATION

Nominal voltage	12V	Dimensions	Total Height	3.9inches (99mm)
Rated capacity (20 hour rate)	7.2Ah		Height	3.66inches (93mm)
Number of cell	6		Length	5.94inches (151mm)
Approx. Weight (Kg/lbs)	2.2/4.85		Width	2.56inches (65mm)

CHARACTERISTICS

Capacity 77° F (25°C)	20 hour rate (0.36A, 10.5V)	7.2Ah
	10 hour rate (0.69A, 10.5V)	6.9Ah
	5 hour rate (1.23A, 10.5V)	6.15Ah
	1 hour rate (4.32A, 9.6V)	4.32Ah
	1C (7.2A, 9.6V)	32min
	3C (21.6A, 9.6V)	7min
Internal Resistance	Full charged Battery 77° F (25°C): 25m	
Capacity affected by Temperature (20 hour rate)	104° F (40°C)	102%
	77° F (25°C)	100%
	32° F (10°C)	85%
	5° F (-15°C)	65%
Self-Discharge 68° F (20°C)	Capacity after 3 month storage	90%
	Capacity after 6 month storage	80%
	Capacity after 12 month storage	60%
Max. discharge current	77° F (25°C) 105A (5S)	
Charge (Constant Voltage)	Float: 13.6 - 13.8 V/ 77° F/ (25°C)	
	Cycle: 14.5 - 14.9 V/ 77° F/ (25°C) Max. Current: 1.75A	

BATTERY DIMENSIONS

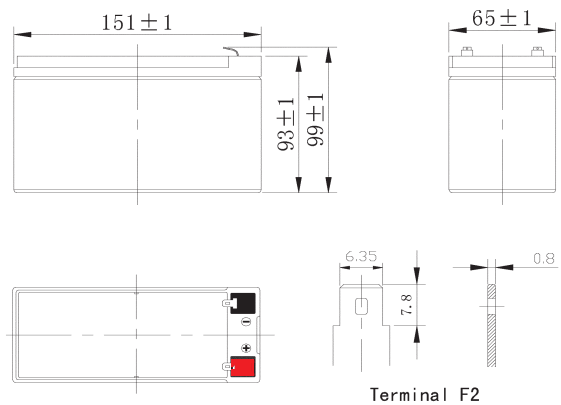

Constant power discharge ratings-watts per cell at 25°C(77°F)

End Point Volts/Cell	5min	10min	15min	30min	45min	1h	2h	3h	5h
1.60V	53.3	35.8	29.7	16.7	12.7	9.50	5.87	3.68	2.38
1.65V	50.0	33.8	28.1	15.8	12.1	9.10	5.69	3.59	2.34
1.70V	46.7	31.7	26.4	15.0	11.5	8.68	5.50	3.49	2.30
1.75V	43.5	29.6	24.8	14.1	10.9	8.25	5.29	3.38	2.25
1.80V	40.2	27.5	23.2	13.2	10.2	7.80	5.06	3.27	2.19



POWER SHIELD

Batteries



PSB12-12 (12V7.2Ah)

GENERAL FEATURES

- Absorbent Glass Mat (AGM) technology for efficient gas recombination of up to 99% and freedom from electrolyte for air transport-complies with LATA/ICAO Special provision A67.
- Not restricted for air transport-complies with LATA/ICAO Special Provision A67.
- UL-recognized component.
- Can be mounted in any orientation.
- Computer designed lead, calcium tin alloy grid for high power density.
- Long service life, float or cyclic applications,
- Maintenance-free operation.
- Low self discharge.
- Case and cover available in both standard and flame retardant ABS.



SPECIFICATION

Nominal voltage	12V	Dimensions	Total Height	3.98inches (101mm)
Rated capacity (20 hour rate)	12Ah		Height	3.74inches (95mm)
Number of cell	6		Length	5.94inches (151mm)
Approx. Weight (Kg/lbs)	3.65/8.04		Width	3.86inches (98mm)

CHARACTERISTICS

Capacity 77° F (25°C)	20 hour rate (0.6A, 10.5V)	12Ah
	10 hour rate (1.14A, 10.5V)	11.4Ah
	5 hour rate (2.04A, 10.5V)	10.2Ah
	1 hour rate (7.2A, 9.6V)	7.2Ah
	1C (12A, 9.6V)	32min
	3C (36A, 9.6V)	7min
Internal Resistance	Full charged Battery 77° F (25°C): 20m	
Capacity affected by Temperature (20 hour rate)	104° F (40°C)	102%
	77° F (25°C)	100%
	32° F (10°C)	85%
	5° F (-15°C)	65%
Self-Discharge 68° F (20°C)	Capacity after 3 month storage	90%
	Capacity after 6 month storage	80%
	Capacity after 12 month storage	60%
Max. discharge current	77° F (25°C) 108A (5S)	
Charge (Constant Voltage)	Float: 13.6 - 13.8 V/ 77° F/ (25°C)	
	Cycle: 14.5 - 14.9 V/ 77° F/ (25°C) Max.Current: 3.0A	

BATTERY DIMENSIONS

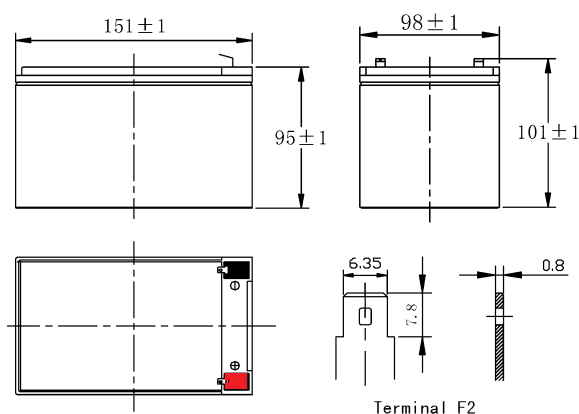

Constant power discharge ratings-watts per cell at 25°C(77°F)

End Point Volts/Cell	5min	10min	15min	30min	45min	1h	2h	3h	5h
1.60V	88.0	59.2	47.7	28.2	21.0	15.6	9.78	6.52	4.24
1.65V	82.5	55.7	45.1	26.8	20.0	14.9	9.49	6.36	4.17
1.70V	77.1	52.3	42.5	25.3	19.0	14.2	9.17	6.19	4.09
1.75V	71.7	48.8	39.8	23.9	18.0	13.5	8.81	6.00	4.00
1.80V	66.4	45.4	37.2	22.4	17.0	12.8	8.43	5.80	3.90

